



Max hose length: 10m



**Mod. 366/C Air operated GREASE pump suitable for 20-30kg drums**

Complete with cover, spring, pressure plate with membrane,  
3m high pressure hose and grease gun (trolley not included)

**Mod. 367/C Air operated GREASE pump suitable for 50-60kg drums**

Complete with cover, spring, pressure plate with membrane,  
3m high pressure hose and grease gun (trolley not included)

**Mod. 368/C Air operated GREASE pump suitable for 200kg drums**

Complete with cover, spring, pressure plate with membrane,  
3m high pressure hose and grease gun (trolley not included)

| Technical Data         | mod. 366            | mod. 367 | mod. 368   |
|------------------------|---------------------|----------|------------|
| Pump ratio             | 50:1                |          |            |
| Max pressure output    | 400 Atm. - 5800 Psi |          |            |
| Max operating pressure | 8 Atm. - 120 Psi    |          |            |
| Delivery capacity      | 2,900 kg/min.       |          |            |
| Shank length           | 450 mm              | 750 mm   | 950 mm     |
| External diam.         | 28 mm               | 28 mm    | 28 mm      |
| Grease drums           | 20-30 kg            | 50-60 kg | 180-200 kg |

**OPTIONAL:**

Mod. 388 TROLLEY for 20-30 kg drums

Mod. 389 TROLLEY for 50-60 kg drums

Mod. 390 TROLLEY for 200 kg drums

Empty drum enclose for mod. 366/C only.

Do not use grafite grease.





For grease drums and with hose more than 10m



**Mod. 366/C/100:1 Air operated GREASE pump suitable for 20-30kg drums**

Complete with cover, spring, pressure plate with membrane, 15m high pressure hose and grease gun (trolley not included)

**Mod. 367/C/100:1 Air operated GREASE pump suitable for 50-60kg drums**

Complete with cover, spring, pressure plate with membrane, 15m high pressure hose and grease gun (trolley not included)

**Mod. 368/C/100:1 Air operated GREASE pump suitable for 200kg drums**

Complete with cover, spring, pressure plate with membrane, 15m high pressure hose and grease gun (trolley not included)

| Technical Data         | mod.<br>366/C/100:1  | mod.<br>367/C/100:1 | mod.<br>368/C/100:1 |
|------------------------|----------------------|---------------------|---------------------|
| Pump ratio             | 100:1                |                     |                     |
| Max pressure output    | 800 Atm. - 12000 Psi |                     |                     |
| Max operating pressure | 8 Atm. - 120 Psi     |                     |                     |
| Delivery capacity      | 2,700 kg/min.        |                     |                     |
| Shank length           | 450 mm               | 750 mm              | 950 mm              |
| External diam.         | 28 mm                | 28 mm               | 28 mm               |
| Grease drums           | 20-30 kg             | 50-60 kg            | 180-200 kg          |

**OPTIONAL:**

Mod. 388 TROLLEY for 20-30 kg drums

Mod. 389 TROLLEY for 50-60 kg drums

Mod. 390 TROLLEY for 200 kg drums

Empty drum enclose for mod. 366/C only.

Do not use grafite grease





Mod. **368/PROF/C**

**“PROFESSIONAL KIT”**

AIR OPERATED GREASE PUMP (100:1) for 180-200 kg drums

Complete with cover, spring, pressure plate with membrane, 1.5m high pressure hose, grease gun, trolley for 200kg drum and 15m hose reel



**Mod. 365**  
**Grease nozzle**  
for air operated  
grease pumps

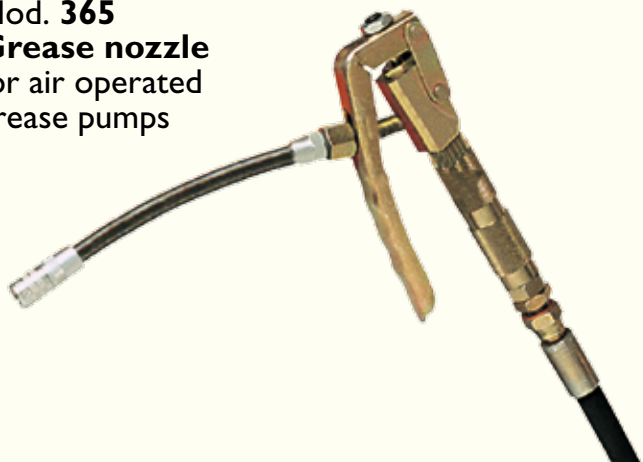

**Mod. 364**  
**Grease meter nozzle**  
with swivel joint for  
grease pumps

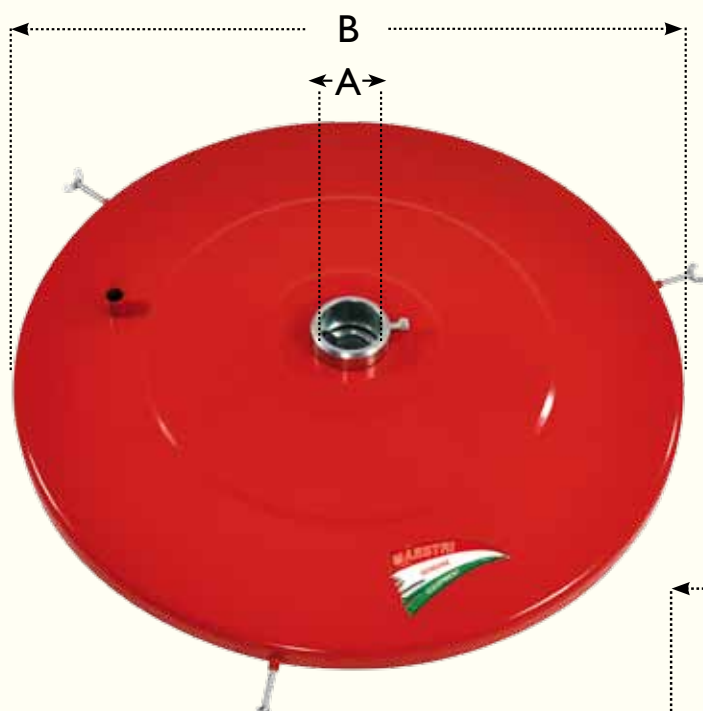

**Mod. 366/06 Cover**  
suitable for 20-30kg drums  
**Mod. 367/06 Cover**  
suitable for 50-60kg drums  
**Mod. 368/06 Cover**  
suitable for 200kg drums

**Measures:**

|             |                    |
|-------------|--------------------|
| Mod. 366/06 | A-30,5mm - B-332mm |
| Mod. 367/06 | A-30,5mm - B-432mm |
| Mod. 368/06 | A-30,5mm - B-620mm |

**Mod. 366/07G Pressure plate with membrane**  
suitable for 20-30kg drum  
**Mod. 367/07G Pressure plate with membrane**  
suitable for 50-60kg drums  
**Mod. 368/07G Pressure plate with membrane**  
suitable for 200kg drums

**Measures:**

|              |                              |
|--------------|------------------------------|
| Mod. 366/07G | A-28,5mm - B-260mm - C-305mm |
| Mod. 367/07G | A-28,5mm - B-325mm - C-390mm |
| Mod. 368/07G | A-28,5mm - B-545mm - C-585mm |

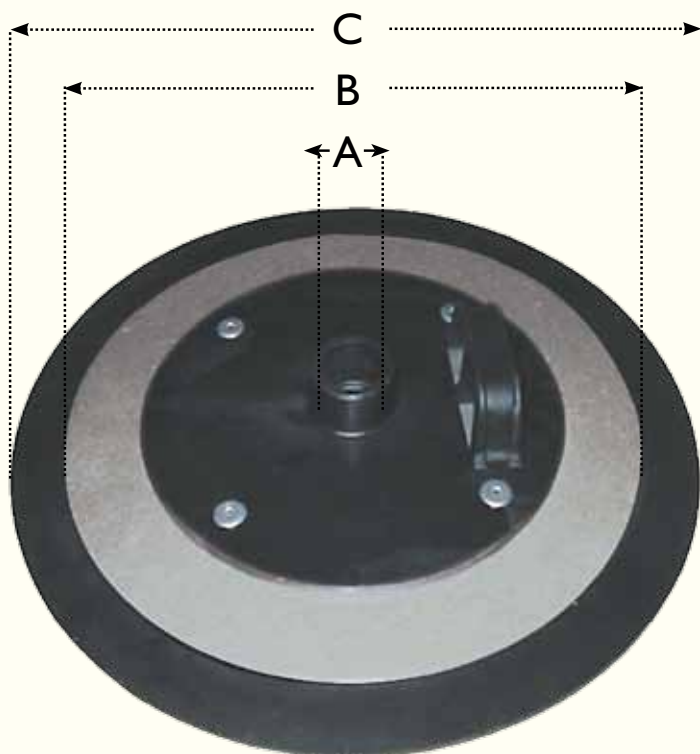

# MAESTRI ACCESSORIES FOR AIR OPERATED GREASE PUMPS

Mod. 373  
3m **High pressure hose** for air operated pumps  
(1/4"F-1/4"F)

Mod. 375  
5m **High pressure hose** for air operated pumps  
(1/4"F-1/4"F)

Mod. 379  
10m **High pressure hose** for air operated pumps  
(1/4"F-1/4"F)



Mod. 366/21  
**Swivel joint**  
(1/4"F-1/4"M)

Mod. 366/90  
**Pressure reducer**



Mod. 366/91  
**Condensate separator with pressure reducer**



## Pumps (no accessories)

Mod. 366/05  
**Air operated GREASE pump (50:l)**  
for 20-30kg drums

Mod. 367/05  
**Air operated GREASE pump (50:l)**  
for 50-60kg drums

Mod. 368/05  
**Air operated GREASE pump (50:l)**  
for 180-200kg drums

## Pumps (no accessories) for hose more than 10m

Mod. 366/05/100:l  
**Air operated GREASE pump (100:l)**  
for 20-30kg drums

Mod. 367/05/100:l  
**Air operated GREASE pump (100:l)**  
for 50-60kg drums

Mod. 368/05/100:l  
**Air operated GREASE pump (100:l)**  
for 180-200kg drums

Technical data: see pag. 2 and pag. 3

Mod. 930

**Automatic reel-hose** with swivel bracket  
(hose not included)

Mod. 931

**Automatic reel-hose** with swivel bracket  
complete with 15m high pressure grease hose



Mod. 930/MAN

**Manual reel-hose**  
swivel bracket not available  
and hose not included

Mod. 931/MAN

**Manual reel-hose**  
complete with 20m high pressure grease hose  
swivel bracket not available



# **MAESTRI** METAL BASES for 200kg DRUMS

(Drum not included)



Mod. **BASE 1**  
**Metal base base** for one 200kg DRUM  
 Capacity: 208L - Measures: 92x83x34cm  
 Weight: 50Kg



Mod. **BASE 2**  
**Metal base base** for two 200kg DRUMS  
 Capacity: 286L - Measures: 135x83x34cm  
 Weight: 55Kg



Mod. **BASE 1 COMP**  
**Metal base base** for one 200kg DRUM  
 with drilled steel plate and posts  
 Capacity: 208L - Measure: 92x83x230cm  
 Weight: 80Kg



Mod. **BASE 2 COMP**  
**Metal base base** for two 200kg DRUMS  
 with drilled steel plate and posts  
 Capacity: 286L - Measures: 135x83x230cm  
 Weight: 90Kg

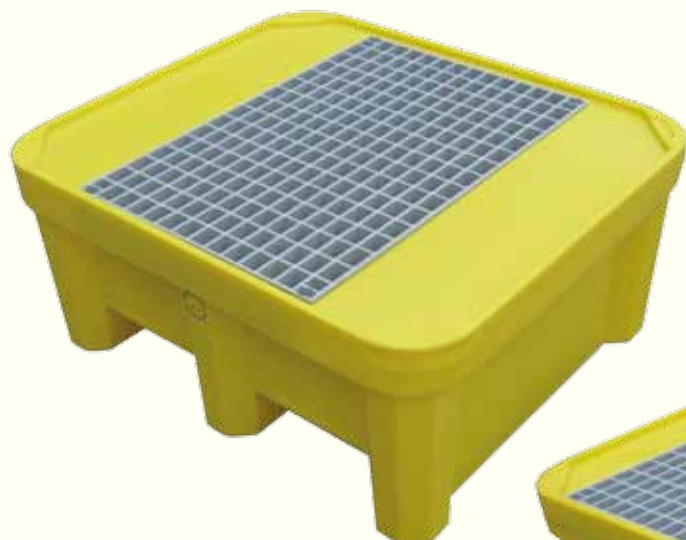

Mod. **BASE1 PL**  
**Plastic base for one 200L drum**  
Capacity: 225L  
Dimensions: 920x800xh420mm

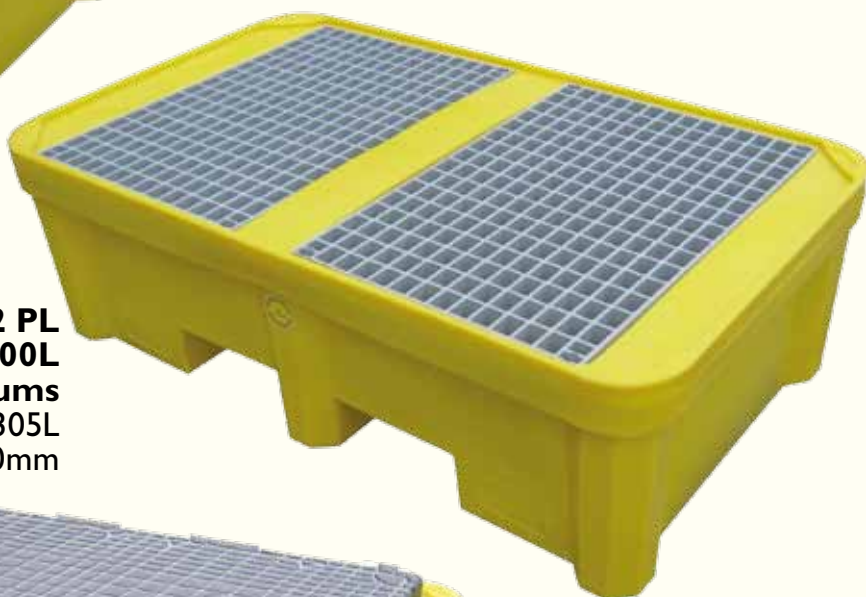

Mod. **BASE2 PL**  
**Plastic base for two 200L drums**  
Capacity: 305L  
Dimensions: 1350x800xh420mm



Mod. **BASE4 PL**  
**Plastic base for four 200L drums**  
Capacity: 500L  
Dimensions: 1350x1350xh490mm

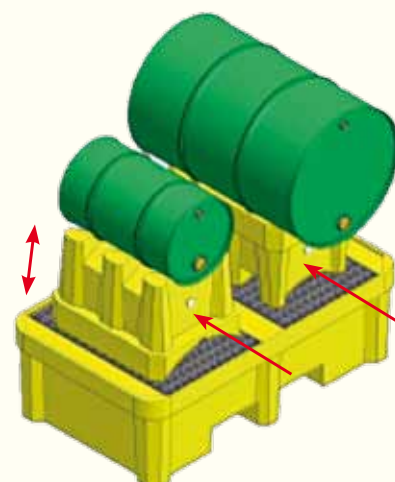

**OPTIONAL:**  
Mod. **PFP**  
**Plastic holder for 50-200L drums**  
(turn up or down for 50 or 200L drums)

**Technical data:**

Range of containment sump for drums or jerrycans made in polyethylene and equipped with a grid in polypropylene. Pallettized for easy handling emptiness and cleaning. Suitable metal supports or polyethylene allow the creation of custom storage zones adapting to the single needs.



**Mod. 369/05**

**Maxi air operated grease pump** for 200kg drums

Flow rate: 15 kg/min

Pump ratio: 30:1

Max output pressure: 240Atm.

Weight: 18kg Outlet thread: 1" M

## OPTIONAL:

**Mod. 369/06**

**Cover for 200kg drums**



**Mod. 369/07G**

**Pressure plate**  
with membrane  
for 200kg drums



**Mod. 369/T3**

3m R2 1"FX1" F hose

**Mod. 369/T5**

5m R2 1"FX1" F hose

**Mod. 369/T10**

10m R2 1"FX1" F hose

**Mod. 369/RT**

**Valve**

Inlet thread: 1" M

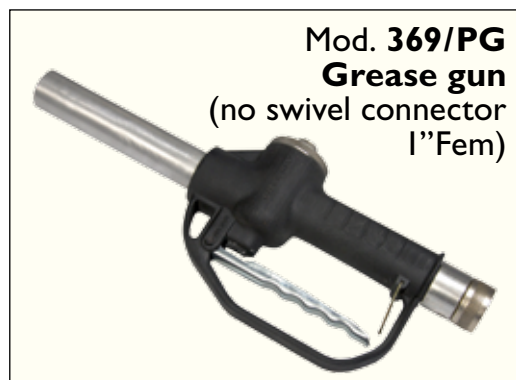

**Mod. 369/PG**

**Grease gun**

(no swivel connector  
1" Fem)



**Mod. 369/PCE**

**Grease gun with**

electronic flow meter  
(no swivel connector  
1" Fem)

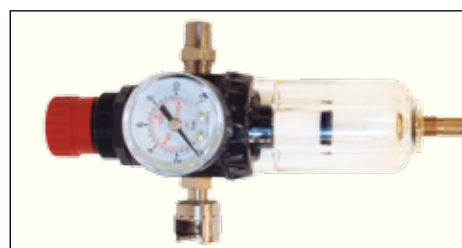

**Mod. 369/FS**

**Condensate separator**  
with pressure reducer 1/2"



Mod. **316NEW/CARR**

**Foot grease pump with trolley**  
complete with 2,5m hose, valve,  
130mm flexible hose and 4 jaw fitting

**Capacity: 16Kg**

**Max pressure: 200bar - 2840psi**



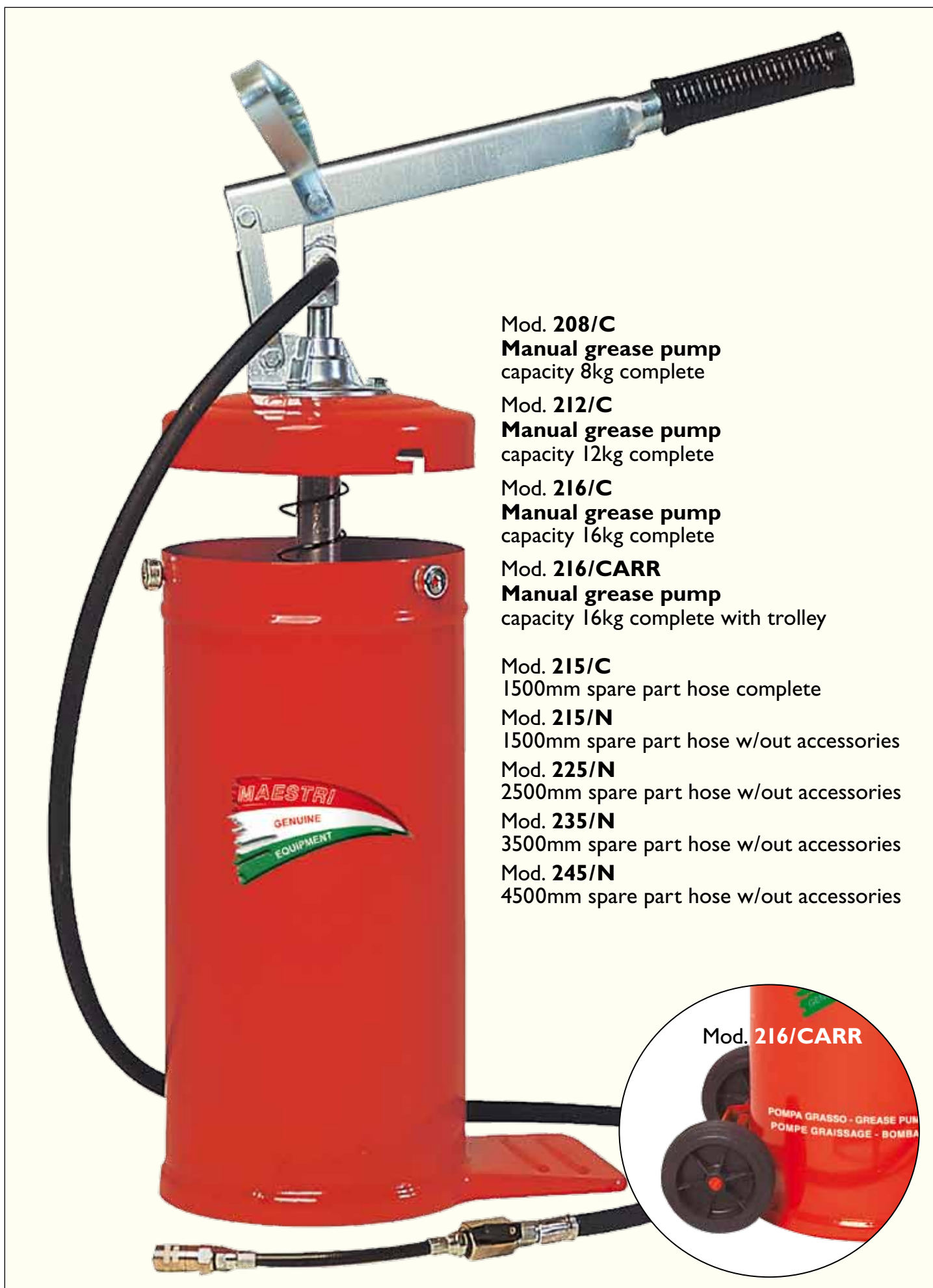

Mod. **208/C**

**Manual grease pump**  
capacity 8kg complete

Mod. **212/C**

**Manual grease pump**  
capacity 12kg complete

Mod. **216/C**

**Manual grease pump**  
capacity 16kg complete

Mod. **216/CARR**

**Manual grease pump**  
capacity 16kg complete with trolley

Mod. **215/C**

1500mm spare part hose complete

Mod. **215/N**

1500mm spare part hose w/out accessories

Mod. **225/N**

2500mm spare part hose w/out accessories

Mod. **235/N**

3500mm spare part hose w/out accessories

Mod. **245/N**

4500mm spare part hose w/out accessories

Mod. **216/CARR**

POMPA GRASSO - GREASE PUMP  
POMPE GRAISSAGE - BOMBA

## GREASE PUMP KIT with 4kg cartridge



Mod. 312/KIT  
**MANUAL GREASE PUMP**  
 capacity 12kg complete with 4kg cartridge  
 Refill: Manual 12kg  
 Cartridge 4kg

Mod. 204  
**4kg Grease drum**  
 Lithium Grease  
 Grease type:  
 GL EP 2 CHIARO (65L)



Mod. 204/MAX  
**4kg Grease drum**  
 Superior **BLUE MAX** grease  
 extremely adhesive,  
 water and max pressure  
 resistant and anti-rust.  
 Designed for agricultural  
 and earth motion  
 machines.  
 Grease type:  
 GL 2 AAP ISO  
 460 BLU (65L)





Mod. 333/C  
**Manual GREASE pump**  
suitable for 20-30kg drums  
Complete with cover, spring,  
pressure plate with membrane,  
1.5m hose, valve, 130mm flexible hose  
and 4 jaw fittings  
(trolley and empty drum not included)

**Optional:**  
Mod. 388  
Trolley for 20-30 kg drums



Mod. 305/C  
**Manual GREASE Pump**  
suitable for 5kg drums  
Complete with cover, spring,  
pressure plate with membrane,  
1.5m hose, valve,  
130mm flexible hose  
and 4 jaw fittings  
(empty drum not included)



**Mod. 322/C****Manual GREASE pump kit 750 bar**

Kit for original full 18/20 kg drums complete:

- Manual grease pump
- Dispensing gun with mode selector\*
- 1,5m flexible hose
- Ø 330mm Cover
- Follower plate with membrane

**Mod. 315/C****Manual GREASE pump kit 750 bar**

Capacity of the tank: 5kg

- Manual grease pump
- Dispensing gun with mode selector\*
- 1,5m flexible hose

Manual operated greasing kit composed by a spring loaded pump which feed a booster gun able to reach pressure up to 750 bar. This pump can be differently used by changing the mode selector position:

- \*1) Flow rate 0,3g/750bar
- \*2) Flow rate 1,1g/stroke on lever
- \*3) Continuous flow rate with low pressure opening the lever



**Mod. 777**  
**Air GREASE gun kit “double use”**  
Bulk or 600g Cartridge Ext. Ø 56mm  
(mod.112-112MAX) refill,  
600mm flexible hose and 4-jaw fitting

**Mod. 777/110**  
**Air GREASE gun kit “double use”**  
Bulk or 550g Cartridge Ext. Ø 53mm  
(mod.113) refill,  
600mm flexible hose and 4-jaw fitting

**Mod. 778**  
**Air GREASE gun kit “double use”**  
Bulk or 400g Cartridge Ext. Ø 52mm  
(mod.114-114MAX) refill,  
300mm flexible hose and 4-jaw fitting

**Air operated grease gun continuous duty**

|                      |           |
|----------------------|-----------|
| Max inlet air:       | 6 bar     |
| Max outlet pressure: | 300 bar   |
| Max flow rate:       | 300 g/min |
| Pump ratio:          | 50:1      |





## Mod. 780

### Air GREASE gun kit "double use"

Bulk or 400g Cartridge Ext. Ø 52mm  
(mod.114) refill,  
 • 3 cartridge 400g  
 • 300mm flexible hose  
 • 4-jaw fitting  
 (mod.114-114MAX) refill



## Mod. 779/110

### Air GREASE gun kit "double use"

Bulk or 550g Cartridge Ext. Ø52mm  
(mod.113) refill,  
 • 3 cartridge 550g  
 • 600mm flexible hose  
 • 4-jaw fitting  
 (Mod.777/110 and cartridges mod.113)



## Mod. 779

### Air GREASE gun kit "double use"

Bulk or 600g Cartridge Ext. Ø56mm  
(mod.112-112MAX) refill,  
 • 3 cartridge 600g  
 • 600mm flexible hose  
 • 4-jaw fitting  
 (Mod.777 and cartridges mod.112)

### Air operated grease gun continuous duty

|                      |           |
|----------------------|-----------|
| Max inlet air:       | 6 bar     |
| Max outlet pressure: | 300 bar   |
| Max flow rate:       | 300 g/min |
| Pump ratio:          | 50:1      |

**RED SERIES**



**Mod. 103/RS**  
**Hand operated**  
**lever grease gun**  
 Capacity 300g  
 (Bulk manual refill only)



**Mod. 105/RS**  
**Hand operated**  
**lever grease gun**  
 Capacity 500g  
 (Bulk manual refill only)



**Mod. 110/RS**  
**Hand operated**  
**lever grease gun**  
 Capacity 1000g  
 (Bulk manual refill only)



**Mod. 111/RS**  
**Hand operated**  
**lever grease gun**  
 600g cartridge refill only



(cartridge not included)

## BLACK SERIES



**Mod. 103/BR**  
**Hand operated**  
**lever grease gun**  
 Capacity 300g (Bulk manual refill only)



**Mod. 105/BR**  
**Hand operated**  
**lever grease gun**  
**"double use"**  
 Bulk or 400g Cartridge  
 Ext. Ø 52mm (mod.114-114MAX) refill  
 (cartridge not included)



**Mod. 110/BR**  
**Hand operated**  
**lever grease gun**  
**"double use"**  
 Bulk or 550g Cartridge  
 Ext. Ø 52mm (mod.113) refill  
 (cartridge not included)



**Mod. 111/BR**  
**Hand operated**  
**lever grease gun**  
**"double use"**  
 Bulk or 600g Cartridge  
 Ext. Ø 56mm (mod.112-112MAX) refill  
 (cartridge not included)





Mod. 131

**Hand operated  
lever grease gun kit**

DOUBLE USE" Bulk or 400g Cartridge  
Ext. Ø 52mm (mod.114-114MAX) refill

- 400g cartridge
  - 300mm flexible hose
  - 4-jaw fitting
  - Single carton box
- (Mod.105/BR+cartridge mod.114)



Mod. 132

**Hand operated  
lever grease gun kit**

DOUBLE USE" Bulk or 550g Cartridge  
Ext. Ø 52mm (mod.113) refill

- 550g cartridge
  - 600mm flexible hose
  - 4-jaw fitting
  - Single carton box
- (Mod.110/BR+cartridge mod.113)



Mod. 133

**Hand operated  
lever grease gun kit**

DOUBLE USE" Bulk or 600g Cartridge  
Ext. Ø 56mm (mod.112-112MAX) refill

- 600g cartridge
  - 600mm flexible hose
  - 4-jaw fitting
  - Single carton box
- (Mod.111/BR+cartridge mod.112)



**Mod. 124**

**Hand operated  
lever grease gun kit**

DOUBLE USE™ Bulk or 400g Cartridge  
Ext. Ø 52mm (mod.114-114MAX) refill

- 8x400g cartridges
- 300mm flexible hose
- 4-jaw fitting
- Single carton box  
(Mod.105/BR+ 8 cartridges mod.114)



**Mod. 125**

**Hand operated  
lever grease gun kit**

DOUBLE USE™ Bulk or 550g Cartridge  
Ext. Ø 52mm (mod.113) refill

- 6x550g cartridges
- 600mm flexible hose
- 4-jaw fitting
- Single carton box  
(Mod.110/BR+ 6 cartridges mod.113)



**Mod. 134**

**Hand operated  
lever grease gun kit**

DOUBLE USE™ Bulk or 600g Cartridge  
Ext. Ø 56mm (mod.112-112MAX) refill

- 6x600g cartridges
- 600mm flexible hose
- 4-jaw fitting
- Single carton box  
(Mod.111/BR+ 6 cartridges mod.112)

## Grease gun kit **PROFESSIONAL** Made in Italy



Mod. I05/PRO-KIT  
**Hand operated lever grease gun kit**  
400g Cartridge Ext. Ø 52mm  
(I14-I14MAX) refill only (not bulk refill)

Complete with:

- 400g cartridge I14MAX
- 500mm flexible hose with spring
- 4-jaw fitting “**SUPER MAXIMA**”
- Special single carton box

## Grease gun kit **PROFESSIONAL** Made in Italy



Mod. III/PRO-KIT  
**Hand operated lever grease gun kit**  
600g Cartridge Ext. Ø 56mm  
(I12-I12MAX) refill only (not bulk refill)

Complete with:

- 600g cartridge I12MAX
- 500mm flexible hose with spring
- 4-jaw fitting “**SUPER MAXIMA**”
- Special single carton box





**Mod. 145/GR**  
**Pressure Syringe**  
 External Diam.: 45mm  
 Capacity 150g  
 with LUB fitting (convex)  
 with ZERCH fitting (concave)



**Mod. 116**  
**Manual grease gun kit**  
 85g Cartridges refill only  
 (not for manual refill)  
 • 85g Cartridge  
 • 300mm flexible hose  
 • Rigid pipe  
 • 4Jaw fittings  
 Max pressure: 200 atm  
 Flow rate: 60g/min (0,6g/strike)



**Mod. 116/CRT**  
 3x85g Cartridges kit



**Mod. 117**  
**Manual grease gun kit**  
 400g Cartridges refill only  
 (not for manual refill)  
 • 400g Cartridge  
 • 300mm flexible hose  
 • Rigid pipe  
 • 4Jaw fittings  
 Max pressure: 200 atm  
 Flow rate: 60g/min (0,6g/strike)

**Max pressure: 400 bar - 5680psi - Max flow rate: 50g/min.**



**12V**

**Mod. 664**

### **12V GREASE BATTERY KIT**

500g Bulk manual and 400g cartridge refill (mod.114-114MAX)

- 2 Batteries
  - Battery charger
  - 500mm flexible hose with spring
  - 4 Jaw fitting
- (plastic suitcase included)

**Mod. 665**

### **12V GREASE BATTERY KIT**

800g Bulk manual and 550g cartridge refill (mod.113)

- 2 Batteries
  - Battery charger
  - 500mm flexible hose with spring
  - 4 Jaw fitting
- (plastic suitcase included)

**Mod. 666**

### **12V GREASE BATTERY KIT**

1000g Bulk manual and 600g - cartridge refill (mod.112-112MAX)

- 2 Batteries
  - Battery charger
  - 500mm flexible hose with spring
  - 4 Jaw fitting
- (plastic suitcase included)

**Max pressure: 600 bar - 8500psi - Max flow rate: 75g/min.**



**Mod. 668**

## **18V GREASE BATTERY KIT**

500g Bulk manual and 400g cartridge refill (mod.114-114MAX)

- 2 Batteries
  - Battery charger
  - 500mm flexible hose with spring
  - 4 Jaw fitting
- (plastic suitcase included)

**Mod. 669**

## **18V GREASE BATTERY KIT**

800g Bulk manual and 550g cartridge refill (mod.113)

- 2 Batteries
  - Battery charger
  - 500mm flexible hose with spring
  - 4 Jaw fitting
- (plastic suitcase included)

**Mod. 670**

## **18V GREASE BATTERY KIT**

1000g Bulk manual and 600g cartridge refill (mod.112-112MAX)

- 2 Batteries
  - Battery charger
  - 500mm flexible hose with spring
  - 4 Jaw fitting
- (plastic suitcase included)



**Lithium Grease for general lubrication (NLG2)**



**Mod. II2**  
**600g LITHIUM**  
**GREASE CARTRIDGE**  
 (Ext. Ø 56mm)  
 (12pcs./carton)

Designed for Mod.:  
**III/BR - III/RS - 777**  
**666 - 670**

**Mod. II3**  
**550g LITHIUM**  
**GREASE CARTRIDGE**  
 (Ext. Ø 52mm)  
 (12pcs./carton)

Designed for Mod.:  
**II0/BR - 779/II0**  
**665 - 669**

**Mod. II4**  
**400g LITHIUM**  
**GREASE CARTRIDGE**  
 (Ext. Ø 52mm)  
 (12pcs./carton)

Designed for Mod.:  
**I05/BR - 778 - 664 - 668**

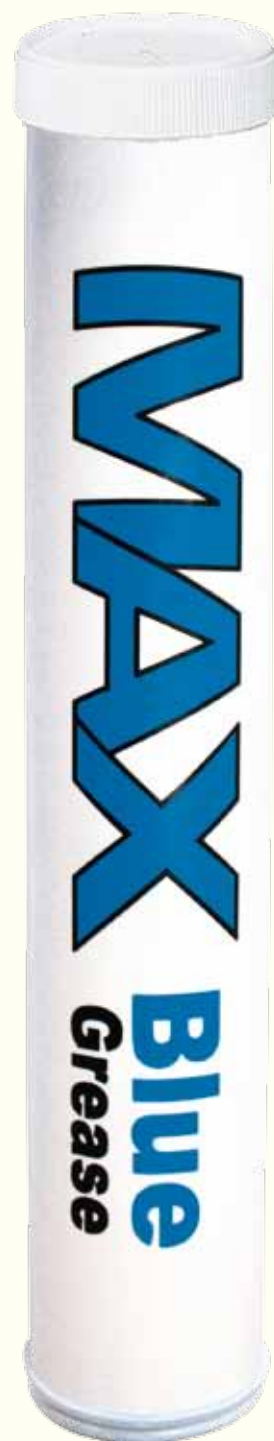
**MAX****Blue  
Grease**

**Mod. 112/MAX**  
**600g BLUE GREASE**  
**CARTRIDGE**  
(Ext. Ø 56mm)  
(12pcs./carton)

**Mod. 114/MAX**  
**400g BLUE GREASE**  
**CARTRIDGE**  
(Ext. Ø 52mm)  
(12pcs./carton)

Designed for Mod.:  
**111/BR - 111/RS - 777 - 666 - 670**

Designed for Mod.:  
**105/BR - 778 - 664 - 668**

**Superior Blue grease.**  
**Extremely adhesive, water and max pressure resistant and anti-rust.**  
**Designed for agricultural and earth motion machines.**

Mod. 318  
**18kg Grease drum**  
Lithium Grease  
Grease type:  
GL EP 2 CHIARO (65L)



Mod. 204  
**4kg Grease drum**  
Lithium Grease  
Grease type:  
GL EP 2 CHIARO (65L)



Mod. 318/MAX  
**18kg Grease drum**  
Superior **BLUE MAX** grease  
Extremely adhesive, water and max pressure  
resistant and anti-rust.  
Designed for agricultural and earth motion machines.  
Grease type: GL 2 AAP ISO 460 BLU (65L)



Mod. 204/MAX  
**4kg Grease drum**  
Superior **BLUE MAX** grease  
Extremely adhesive,  
water and max pressure  
resistant and anti-rust.  
Designed for agricultural and  
earth motion machines.  
Grease type:  
GL 2 AAP ISO 460 BLU (65L)





# **MAESTRI** 50kg and 180kg GREASE DRUMS



Mod. FT180  
**LITHIUM GREASE**  
Capacity 180kg

Mod. FT50  
**LITHIUM GREASE**  
Capacity 50kg



Mod. FT180/MAX  
**“MAX” Blue Grease**  
Capacity 180kg

Mod. FT50/MAX  
**“MAX” Blue Grease**  
Capacity 50kg





For cartridges refill only:  
Mod. II4/SPEEDY-400 and Mod. II4/SPEEDY-MAX



**Mod. 114/SPEEDY-400 - Mod. 114/SPEEDY-MAX**

Instructions for the cartridges refill on below models:

**120 - 120/ECO - 121 - 121/ECO**

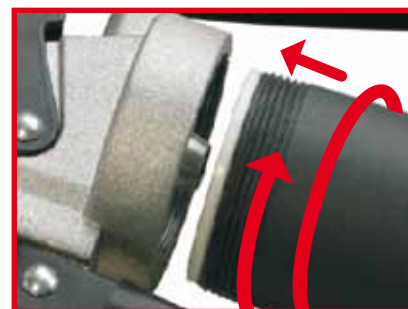
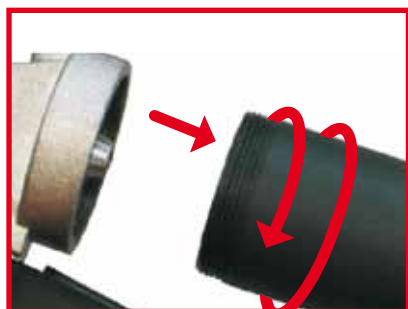

1) Unscrew the tube    2) Insert the cartridge into the tube    3) Screw the tube

.....

Instructions for the cartridges refill on below models:

**664/SPEEDY**

**668/SPEEDY**

**778/SPEEDY**

1)

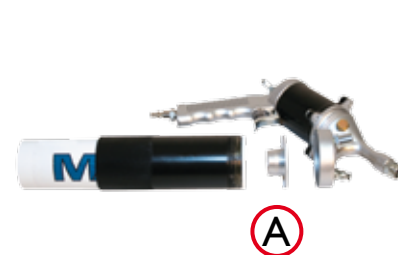

2)



3)



4)



5)



- 1) Unscrew the cap and **check the position of special aluminum nut (A)**
- 2) Remove the aluminum seal
- 3) Check the inside position of the plastic pressure plate
- 4) Insert the cartridge into the tube and press out 2cm of grease from cartridge
- 5) **Check the position of special aluminum nut (A)** and crew the tube on pump.

See the instructions videos on our web:

**[www.maestrispa.it/speedygreasesystem.htm](http://www.maestrispa.it/speedygreasesystem.htm)**



# **MAESTRI** SINGLE LEVER GREASE GUN KIT

for 400ml cartridges



Mod. 121

## **SINGLE LEVER GREASE GUN KIT**

for 400ml cartridges (Mod.114/SPEEDY-400 and Mod.114/SPEEDY-MAX)

Complete with 400ml MAX cartridge, 500mm flexible hose with spring, “SUPERMAXIMA” 4 Jaw fittings and special carton box. Magnetic stand (more than 60kg force).

Aluminum special adapter for 400g screw cartridges (Mod.114/PRO-400 and Mod.114/PRO-MAX)

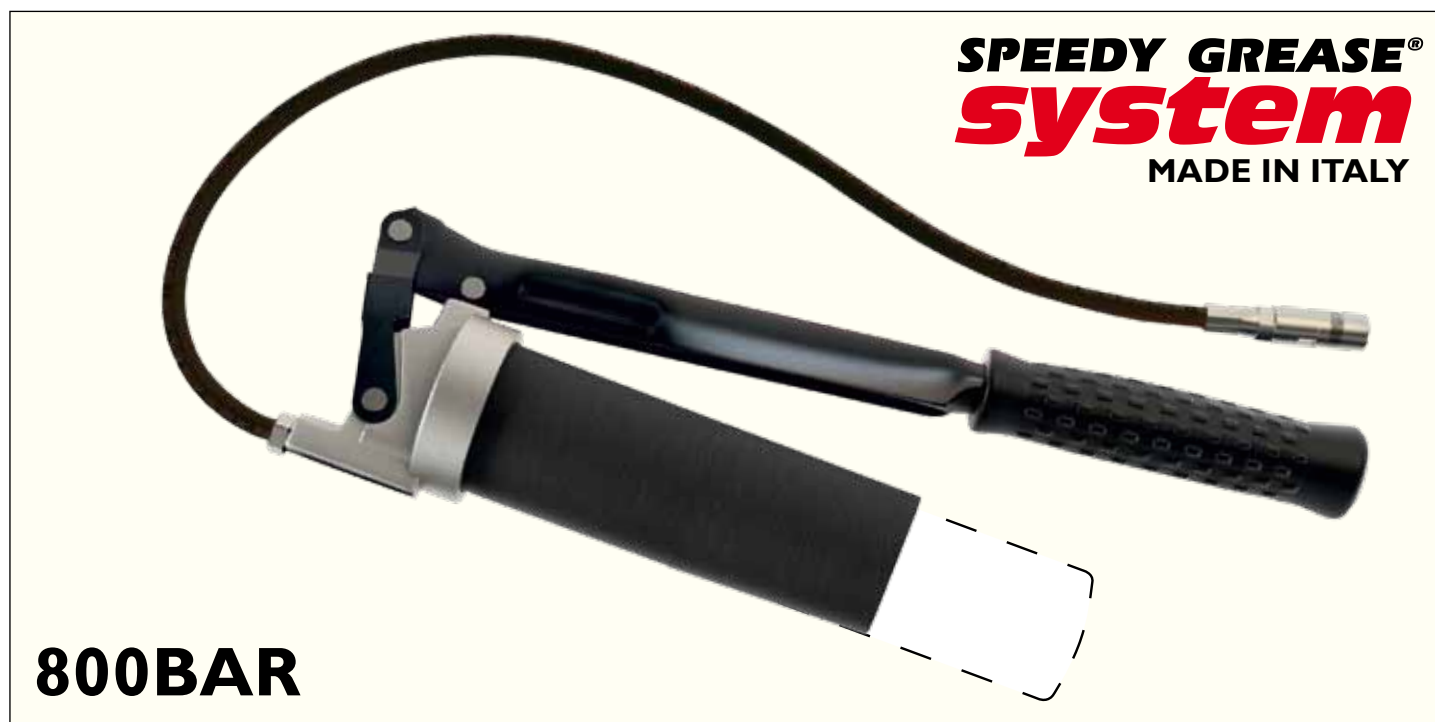

Mod. 121/ECO

## **SINGLE LEVER GREASE GUN KIT “ECO-VERSION”**

for 400ml cartridges (Mod.114/SPEEDY-400 and Mod.114/SPEEDY-MAX) Complete with 500mm flexible hose and 4 Jaw fittings (without cartridge and special carton box). Magnetic stand (more than 60kg force).

Aluminum special adapter for 400g screw cartridges (Mod.114/PRO-400 and Mod.114/PRO-MAX)

# **MAESTRI** DOUBLE LEVER GREASE GUN KIT

for 400ml cartridges



Mod. 120

## **DOUBLE LEVER GREASE GUN KIT**

for 400ml cartridges (Mod.114/SPEEDY-400 and Mod.114/SPEEDY-MAX) Complete with 400ml MAX cartridge, 500mm flexible hose with spring, “**SUPERMAXIMA**” 4 Jaw fittings and special carton box. Magnetic stand (more than 60kg force).

**Aluminum special adapter for 400g screw cartridges (Mod.114/PRO-400 and Mod.114/PRO-MAX)**

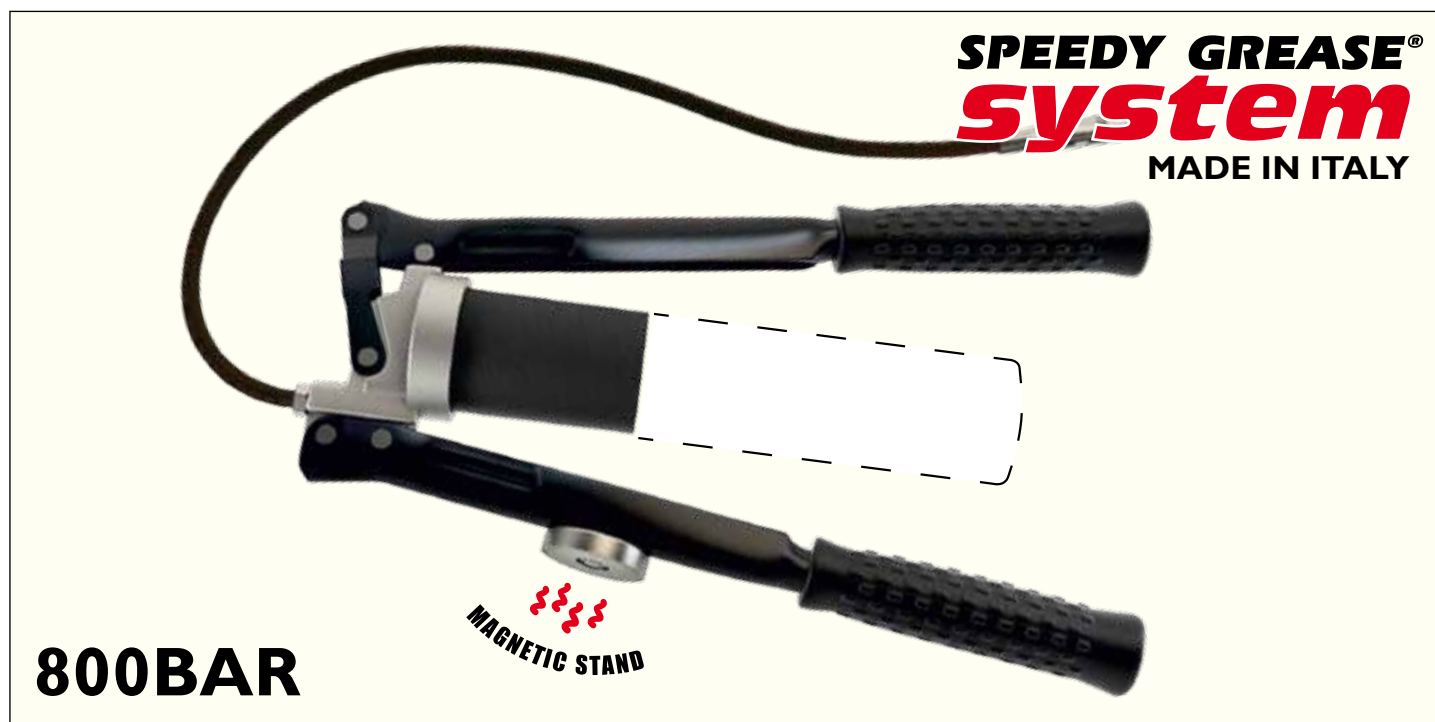

Mod. 120/ECO

## **DOUBLE LEVER GREASE GUN KIT “ECO-VERSION”**

for 400ml cartridges (Mod.114/SPEEDY-400 and Mod.114/SPEEDY-MAX)

Complete with 500mm flexible hose and 4 Jaw fittings (without cartridge and special carton box).

Magnetic stand (more than 60kg force).

**Aluminum special adapter for 400g screw cartridges (Mod.114/PRO-400 and Mod.114/PRO-MAX)**

**SPEEDY GREASE®**  
**system**  
 MADE IN ITALY



**Mod. 778/SPEEDY**

**AIR OPERATED GREASE GUN**

for 400g cartridges (Mod.114/SPEEDY-400 e Mod.114/SPEEDY-MAX)

Complete with 400ml MAX cartridge, 300mm flexible hose and 4 Jaw fittings.

**Aluminum special adapter for 400g screw cartridges (Mod.114/PRO-400 and Mod.114/PRO-MAX)**

Continuous duty air operated grease gun – Max inlet pressure: 6 bar – Max outlet pressure: 300 bar - Max flow rate: 300 g/min  
 Gun ratio: 50:1 - Max pressure: 400bar - Flow rate: 50g/min.



**Mod. 664/SPEEDY**  
**12V GREASE GUN**

for 400ml cartridges (Mod.114/SPEEDY-400 e Mod.114/SPEEDY-MAX)

Complete with 400ml MAX cartridge, 2 batteries, battery charger, 500mm flexible hose with spring, 4 Jaw fitting and special plastic suitcase.

**Aluminum special adapter for 400g screw cartridges (Mod.114/PRO-400 and Mod.114/PRO-MAX)**



**12V**

Max pressure: 400 bar  
 Flow rate: 50g/min.

**SPEEDY GREASE®**  
**system**  
 MADE IN ITALY



# I8V GREASE GUN KIT

or 400ml cartridges



Max pressure: 600bar  
Flow rate: 75g/min.

**SPEEDY GREASE®**  
**system**  
MADE IN ITALY

## Mod. 668/SPEEDY I8V GREASE GUN

for 400ml cartridges (Mod.II4/SPEEDY-400 e Mod.II4/SPEEDY-MAX)

Complete with 400ml MAX cartridge, 2 batteries, battery charger, 500mm flexible hose with spring, 4 Jaw fitting and special plastic suitcase.

Aluminum special adapter for 400g screw cartridges (Mod.II4/PRO-400 and Mod.II4/PRO-MAX)

### Instructions for the cartridges refill:

cartridges refill: Mod. II4/SPEEDY-400 and Mod.II4/SPEEDY-MAX

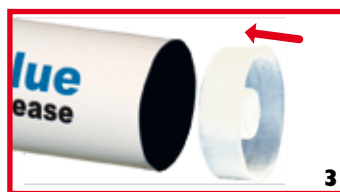

screw cartridges refill: Mod. II4/PRO-400 and Mod. II4/PRO-MAX

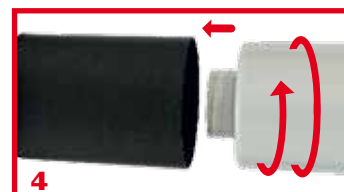





Mod. 114/SPEEDY-400  
**GREASE CARTRIDGE** Capacity 400ml

**400 LITHIUM Grease**

**LITHIUM GREASE** Type: GL EP/2 65L  
External diam.: 52mm – Carton box: 12pcs. - min/max temp: -20°C +130°C



Mod. 114/SPEEDY-MAX  
**GREASE CARTRIDGE** Capacity 400ml

**MAX** **Blue**  
**Grease**

**Special BLUE grease for earth machines, industrial vehicles and tractors.**  
Extremely adhesive, water and max pressure resistant and anti-rust.  
External diam.: 52mm - Carton box: 12pcs. - min/max temp: -20°C +130°C





Mod. II4/PRO-400

**400 LITHIUM**  
Grease

Lithium Grease Type: GL



is a registered trade mark of MATO

Mod. II4/PRO-MAX

**MAX Blue**  
Grease

Special BLUE grease for  
earth machines, industrial vehicles  
and tractors

400g screw cartridges refill: Mod.II4/PRO-400 and Mod. II4/PRO-MAX

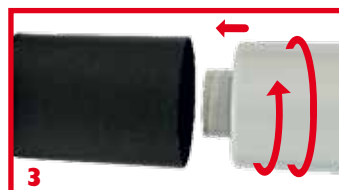

# “PROFESSIONAL SYSTEM” GREASE GUN

Mod. 122

## “PROFESSIONAL SYSTEM” GREASE GUN

for 400g screw cartridges only (Mod.114/PRO-400 and Mod.114/PRO-MAX)

without flexible hose and 4 Jaw fittings

Outlet thread: 10x1F – Max pressure: 400bar/5800psi

Made in Germany



**Attention:**  
**Use with screw cartridges only**



Mod. 123

## “PROFESSIONAL SYSTEM” GREASE GUN

for 400g screw cartridges only

(Mod.114/PRO-400 and Mod.114/PRO-MAX)

without flexible hose and 4 Jaw fittings

Outlet thread: 10x1F - Max pressure: 400bar/5800psi

Made in Germany

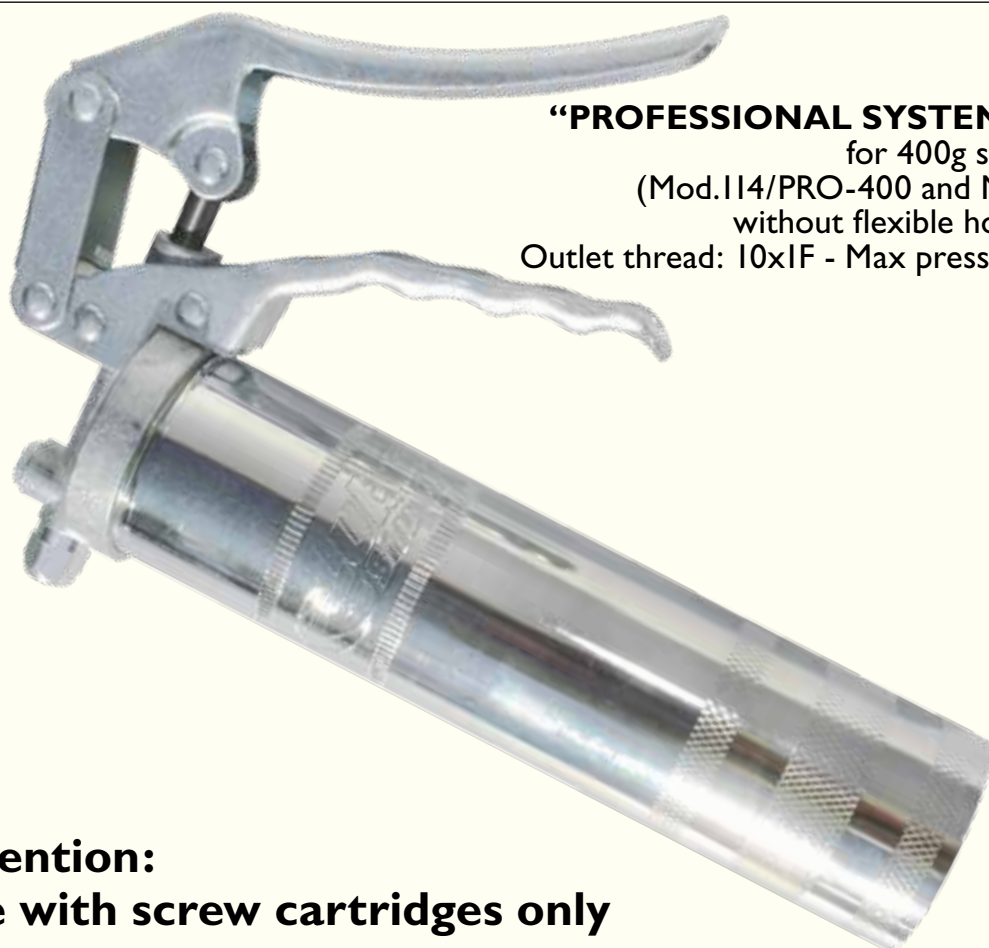

**Attention:**  
**Use with screw cartridges only**





# “PROFESSIONAL SYSTEM” GREASE GUN KIT

Mod. 122/PRO-400  
**“PROFESSIONAL SYSTEM” GREASE GUN KIT**  
 Complete with 400g screw cartridge (Mod.114/PRO-400)  
 300mm flexible hose and 4 Jaw fittings



**for 400g screw cartridges**



Mod. 122/PRO-MAX  
**“PROFESSIONAL SYSTEM” GREASE GUN KIT**  
 Complete with 400g screw cartridge (Mod.114/PRO-MAX)  
 300mm flexible hose and 4 Jaw fittings



**for 400g screw cartridges**



Mod. 123/PRO-400

## “PROFESSIONAL SYSTEM” GREASE GUN KIT

Complete with 400g screw cartridge  
(Mod.114/PRO-400),  
300mm flexible hose and 4 Jaw fittings



**for 400g screw cartridges**



Mod. 123/PRO-MAX

## “PROFESSIONAL SYSTEM” GREASE GUN KIT

Complete with 400g screw cartridge  
(Mod.114/PRO-MAX),  
300mm flexible hose and 4 Jaw fittings



**for 400g screw cartridges**





# **MAESTRI** PRO-400 SCREW GREASE CARTRIDGES

Capacity: 400g



Mod. 114/PRO-400

**GREASE CARTRIDGE** Capacity 400g

# **400** LITHIUM Grease

**LITHIUM GREASE** Type: **GL EP/2 65L**

External diam.: 52mm – Carton box: 12pcs. - min/max temp: -20°C +130°C





# **MAESTRI** PRO-MAX SCREW GREASE CARTRIDGES

Capacity: 400g



Mod. 114/PRO-MAX  
**GREASE CARTRIDGE** Capacity 400g

# **MAX** **Blue** Grease

**Special BLUE grease for earth machines, industrial vehicles and tractors**  
Extremely adhesive, water and max pressure resistant and anti-rust.  
External diam.: 52mm – Carton box: 12pcs. - min/max temp: -20°C +130°C



Electrochemical drive – Universal LITHIUM Grease SF01 - Capacity: 120cc  
Reliable, completely automatic, no maintenance. Work at all position and under water.

Temperature: 0° a + 40° -Max output pressure: 4 bar.

Perma-tec GmbH & Co.KG - Made in Germany

Remove the grease fitting and apply the reducer when necessary.



Mod. **590/IA**  
**"CLASSIC"**  
**AUTOMATIC LUBRICATOR**  
Metal tank - Non-transparent  
High: 99mm Diam.: 70mm  
Thread: ¼"M



Mod. **590/IAT**  
**"FUTURA"**  
**AUTOMATIC LUBRICATOR**  
Plastic tank - Trasparent  
High: 114mm Diam.: 60mm  
Thread: ¼"M

Different colours of activator screw  
for different time of greasing:



Mod. **590/CG**  
**Yellow** 1 month



Mod. **590/CV**  
**Green** 3 months







Mod. **590/CR**  
**Red** 6 months



Mod. **590/CGR**  
**Grey** 12 months

Tests with temperature: 20°

**Periodo di erogazione in mesi alle diverse temperature:**  
Tempo tra attivazione e prima fuoriuscita del  
lubrificante: **1 giorno**

| 120 cm <sup>3</sup> |  |  |  |  |
|---------------------|---|---|---|---|
| a 0°C               | 4   | 8   | 15  | >18   |
| a +10°C             | 2   | 5   | 8   | 18  |
| <b>a +20°C</b>      | <b>1</b>  | <b>3</b>  | <b>6</b>  | <b>12</b>   |
| a +30°C             | 25gg  | 2   | 3   | 6   |
| a +40°C             | 20gg  | 1   | 2   | 3   |

## OPTIONAL: THREAD REDUCERS



Mod. **590/R1**  
Reducer ¼"F-1/8"M

Mod. **590/R2**  
Reducer ¼"F-6xIM

Mod. **590/R3**  
Reducer ¼"F-8xIM

Mod. **590/R4**  
Reducer ¼"F-10xIM

To have the Automatic Lubricator ready to use do not forget to order the required activator coloured screw and the thread reducer if necessary.



**Mod. 590/IAFP**  
**“FLEX” AUTOMATIC LUBRICATOR**

Plastic tank - Trasparent  
Capacity: 60cc  
High: 84.5mm Diam.: 58mm  
Thread: 1/4”M

**Mod. 590/IAFG**  
**“FLEX” AUTOMATIC LUBRICATOR**

Plastic tank - Trasparent  
Capacity: 125cc  
High: 117mm Diam.: 58mm  
Thread: 1/4”M

Electrochemical drive - Universal LITHIUM Grease SF01 - Capacity: 125cc-60cc  
Reliable, completely automatic, no maintenance. Work at all position and under water.

Temperature: -20° a + 60° - Max output pressure: 4 bar.

Perma-tec GmbH & Co.KG - Made in Germany

**Remove the grease fitting and apply the reducer if necessary.**



- Ex-proof certification
- FM certification
- IP 68 protection

## OPTIONAL THREAD REDUCERS



**Mod. 590/R1**  
Reducer 1/4”F-1/8”M

**Mod. 590/R2**  
Reducer 1/4”F-6x1M

**Mod. 590/R3**  
Reducer 1/4”F-8x1M

**Mod. 590/R4**  
Reducer 1/4”F-10x1M





Mod. **595/A100**  
**AUTOMATIC LUBRICATORS**  
**MANUAL REFILL**  
 Capacity: 100cc  
 High: 135mm - max diameter: 77mm  
 Thread: 10X1M



Mod. **595/A220**  
**AUTOMATIC LUBRICATORS**  
**MANUAL REFILL**  
 Capacity: 220cc  
 High: 198mm – max diameter: 77mm  
 Thread: 10X1M

**The Automatic Lubricators** are able to provide all consistencies of NLGI 0-1-2-3-4 grease at any temperature and operating condition without necessity to change the spring.

**Max inlet pressure (when refill the lubricators): 40Bar - 600psi**

The **firsts** adjustment serves as "substitute for the springs" and it has 3 adjustments which make reference to the intensity of the grease emission:

**(L=Light, M=Medium, H=High)**

The **second** adjustment makes reference to the duration expressed in months:

**1 - 3 - 6 - 12**

It displays consumption and allows remote control by means of its full transparence. Immediate activation. No battery or gas. It can be installed indoors, outdoors, remotely, inversely, under water, in either dangerous or uncomfortable points. It keeps lubrication constant and prevents solid matter accumulation. Lubricant installed reserve, reducing lubrication drawbacks, preventing oversights. It saves production stops and very expensive repairs. Easy and fast mounting. Environment friendly: refillable more times, it avoids constant disposal expenses. Fully recyclable.

## OPTIONAL ADAPTER



Mod. **595/R1**  
 Adapter 10x1"F-1/4"M

Mod. **595/R2**  
 Adapter 10x1"F-1/8"M

Mod. **595/R3**  
 Adapter 10x1"F-6x1M

Mod. **595/R4**  
 Adapter 10x1"F-8x1M

Mod. 450  
**"SUPERMAXIMA"**  
 4 Jaw fittings 10x1 female

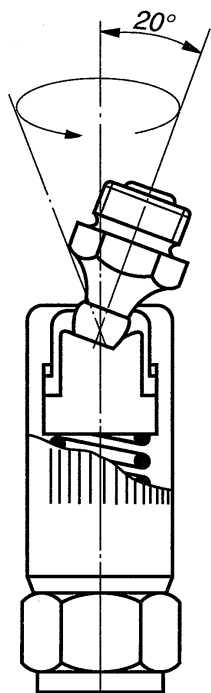

**#1**  
 HIGH  
 PERFORMANCE



Mod. 444/R  
 4 Jaw fittings 10x1 female

Mod. 444/Max  
**"Maxima"** 4 Jaw fittings  
 10x1 female



Mod. 445  
 90° 4 Jaw fittings 10x1 female

Mod. 425  
**Rigid pipe** 10x1M  
 Length: 150mm

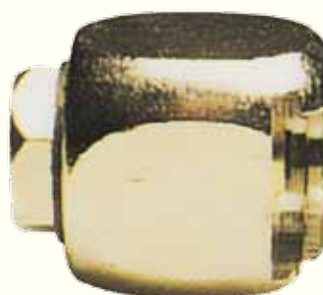

Mod. 488  
**"COUPLER"**  
 for 22mm hexagon  
 fittings (10x1 fem.)



Mod. 404  
**"COUPLER"**  
 for 15mm hexagon  
 fittings (10x1 fem.)



Mod. 490  
**Valve** 10x1 F.M.



| Hydraulic grease fittings |        |
|---------------------------|--------|
| 6x1                       | 500    |
| 8x1                       | 508    |
| 8x1,25                    | 508/25 |
| 10x1                      | 510    |
| 10x1,25                   | 510/25 |
| 10x1,5                    | 510/15 |
| 1/8                       | 520/18 |
| 1/4                       | 520    |
| 12x1,5                    | 510/12 |



Mod. 501 Grease fittings 6x1



| 45° hydraulic grease fittings |          |
|-------------------------------|----------|
| 6x1                           | 530/06   |
| 8x1                           | 530/08   |
| 8x1,25                        | 530/25   |
| 10x1                          | 530/10   |
| 10x1,25                       | 530/1,25 |
| 10x1,5                        | 530/15   |
| 1/8                           | 535/18   |
| 1/4                           | 535      |
| 12x1,5                        | 530/12   |



Mod. 550 Grease fittings for track es. 22 3/8"

Mod. 550L Grease fittings for wheels es. 22 3/8"



| Simple hexagon hydraulic grease fittings |        |
|--|--------|
| 6x1                                      | 580/06 |
| 10x1                                     | 580/10 |
| 10x1,5                                   | 580/15 |
| 1/4                                      | 580/14 |



| 90° hydraulic grease fittings |          |
|-------------------------------|----------|
| 6x1                           | 540/06   |
| 8x1                           | 540/08   |
| 8x1,25                        | 540/25   |
| 10x1                          | 540/10   |
| 10x1,25                       | 540/1,25 |
| 10x1,5                        | 540/15   |
| 1/8                           | 545/18   |
| 1/4                           | 545      |
| 12x1,5                        | 540/12   |



| Double hexagon hydraulic grease fittings |        |
|--|--------|
| 8x1                                      | 585/08 |
| 10x1                                     | 585/10 |
| 10x1,5                                   | 585/15 |
| 1/8                                      | 585/18 |
| 1/4                                      | 585/14 |
| 12x1,5                                   | 585/12 |
| 12x1,25                                  | 585/25 |

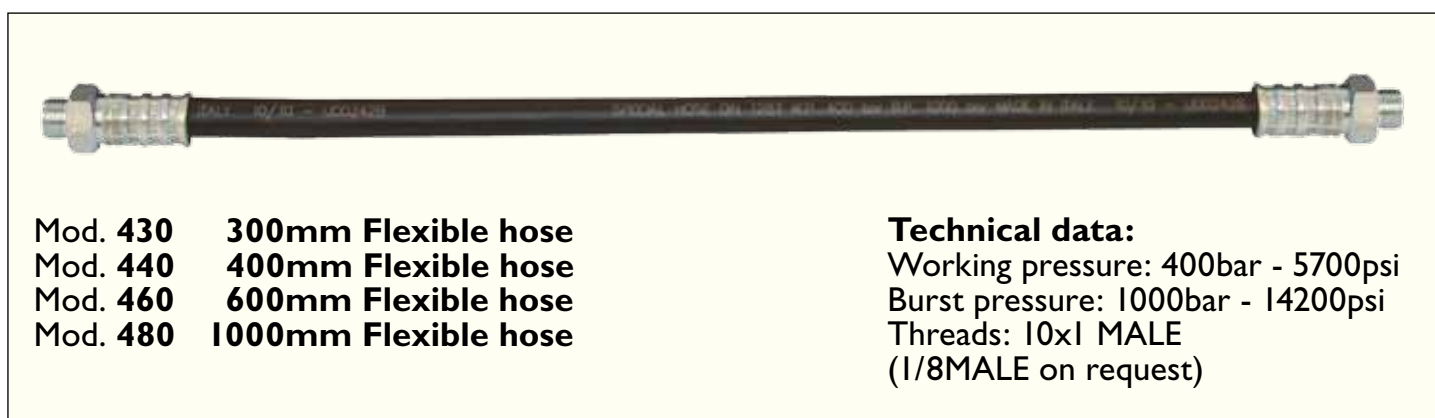

Mod. 430 300mm Flexible hose  
 Mod. 440 400mm Flexible hose  
 Mod. 460 600mm Flexible hose  
 Mod. 480 1000mm Flexible hose

**Technical data:**  
 Working pressure: 400bar - 5700psi  
 Burst pressure: 1000bar - 14200psi  
 Threads: 10x1 MALE  
 (1/8MALE on request)





**Mod. 2400**  
**Grease fittings box**  
(16 sections)

**Grease fittings list:**

|   |         |
|---|---------|
| 50 pcs. grease fittings                 | 6xl     |
| 50 pcs. grease fittings                 | 8xl     |
| 50 pcs. grease fittings                 | 10xl    |
| 50 pcs. grease fittings                 | 10xl,5  |
| 20 pcs. grease fittings                 | 1/4 gas |
| 20 pcs. grease fittings 45°             | 6xl     |
| 20 pcs. grease fittings 45°             | 8xl     |
| 20 pcs. grease fittings 45°             | 10xl    |
| 20 pcs. grease fittings 45°             | 10xl,5  |
| 20 pcs. grease fittings 90°             | 6xl     |
| 20 pcs. grease fittings 90°             | 8xl     |
| 20 pcs. grease fittings 90°             | 10xl    |
| 20 pcs. grease fittings 90°             | 10xl,5  |
| 20 pcs. doublehex. fittings             | 10xl    |
| 5 pcs. coupler for 15mm grease fittings | 10xl    |
| 5 coupler tekalemit                     | 10xl    |



**Mod. 2492**  
**Plastic box** (18 sections)

**Mod. 2490 Plastic box** (16 sections)

**Mod. 2491 Plastic box** (16 sections)

